



Plat of Survey
of
Lot 3 of Certified Survey Map No. 3851,
recorded in Vol. 23 of Certified Survey Maps of Walworth County on
Page 204 and located in the Northwest 1/4 of Section 9, Town 3 North,
Range 17 East, Town of LaFayette, Walworth County, Wisconsin.

Surveyed for: **Dave Bahl**
W3949 Scotch Bush Road
Elkhorn, Wisconsin. 53121



Bearings reference to the Wisconsin State
Plane Coordinate System, South Zone.

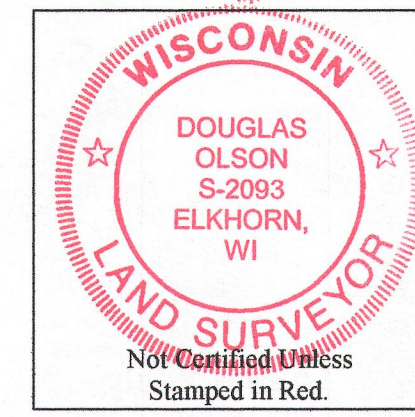

- Notes:
- 1) This survey plat is not certified unless signed and sealed in red ink.
 - 2) This survey is subject to Wisconsin lien laws. This Plat of Survey is the notice of intent to file lien. Lien waiver required.

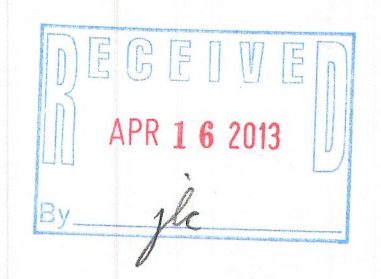

Copyright 2012 by Jensen & Olson Land Surveying, LLC.

All rights reserved. No part of this survey plat may be reproduced or transmitted in any form by any means - graphic, electronic, or mechanical, including photocopying, tracing, or information storage and retrieval systems - without permission in writing from Douglas G. Olson, Jensen & Olson Land Surveying, LLC.

I, Douglas G. Olson, Wisconsin Registered Land Surveyor, do hereby certify that this survey was performed by me, or under my direction in full compliance with the owner's/agent's instructions and Chapter A-E 7 of the Wisconsin Administrative Code "Minimum Standards for Property Surveys"; and that this map is an accurate representation thereof to the best of my knowledge and belief.

Douglas G. Olson
Wisconsin Registered Land Surveyor - 2093

KA385100003 317-963
KA4467-1

Survey date: November 5, 2012.
Revisions:

Scale in Feet
1" = 100'
0' 50' 100' 200' 300'

Jensen & Olson Land Surveying, LLC

45 South Wisconsin Street * P.O. Box 322 * Elkhorn, Wisconsin. 53121
Telephone: (262) 723-3434 * Facsimile: (262) 723-8044
Email: jensen.olson@elknet.net

Legend

Found County Section Corner
Found Iron Pipe
Found Iron Stake
Set Iron Pipe, 1" dia.
Recorded Information
Concrete Cover
Septic Vent
Concrete Surface
Gravel Surface

Sheet 1 of 1 Sheets

Drawing Name:

Job Reference Number
2012.116

2012.116